



2nd March 2021

Dear Parent/Carer

Asymptomatic Testing & Return to School – w/c 8th March 2021

Further to my letter dated 24th February 2021, I am writing to provide some further details about asymptomatic testing on 8th-10th March 2021 and students' full return to the Collegiate from 11th March 2021. *Remote Learning* will continue until 10th March 2021, although there will be **no live lessons or non-live lessons set on the day that students are expected on site for asymptomatic testing**. Teachers may set some "screen-free" tasks beforehand, but students will not be required to log in to Google Classroom on that day. On site provision for vulnerable students and children of key workers will continue until 10th March 2021 and students will be given some alternative activities to engage with on the day that their Year Group is being tested.

Broadly, the schedule for the administration of the first on site lateral flow tests will be as follows:

	<i>Morning Session</i> 9.00am – 11.30am	<i>Afternoon Session</i> 1.00pm – 3.30pm
Monday 8 th March 2021	Year 7	Year 11
Tuesday 9 th March 2021	Year 8	Year 10
Wednesday 10 th March 2021	Year 9	Years 12 & 13

In the next couple of days, students for whom we have received consent for asymptomatic testing will receive confirmation of the date and time of their first lateral flow test and instructions for what to do on the day.

From 11th March 2021, all students should return to the Collegiate for regular lessons, according to their regular timetable (unless unwell, self-isolating or symptomatic). We shall operate the same staggered timings as last term (8.20am – 2.30pm for Years 7-9 and 9.30am – 3.40pm for Years 10-13) and the same system of controls (including "bubbles", staggered breaks/lunches and enhanced cleaning) with some additional features.

Face Masks

Students are already in the habit of wearing a face mask whilst in corridors and other indoor communal areas, except for when eating. This must continue upon our return and, in addition, in accordance with the government's recommendation, students and staff will **now be required to wear a face mask during lessons, as well**. It is important, therefore, that students bring a few face masks each day as they will now be wearing them for longer periods of time. We will not refuse to admit a student who arrives at school without a face mask, but we will charge £1 for any spare masks that we are required to provide. Please notify Mrs Williams, Deputy Principal, at nicole.williams@riddlesdown.org if your child has a medically diagnosed condition or disability that would make wearing a face mask difficult so that we can consider whether to grant an exemption. This additional measure will be for the remainder of this term, in the first instance, and will be reviewed prior to our return after the Easter break.

Uniform & PE Kit

In order to avoid use of the PE changing rooms at this time, students should wear their regular Kukri PE kit to school on days when they have PE lessons. The PE changing rooms will not be available for use for the remainder of this term; we shall review this arrangement for the Summer Term. Students may additionally wear their school jumpers and/or blazers for warmth, if they wish, but non-uniform items (e.g. hoodies) should not be brought or worn. On all other days, students should wear full regular uniform, including their blazers and black shoes. [Hewitts of Croydon](#) are processing online delivery orders, even though their store remains closed at this time.

College VI Common Room & Library

To avoid congregations, the College VI Common Room and the Library will not be accessible for the remainder of this term in the first instance. We recognise the difficulties that this may cause, but feel that these two areas are particularly prone to social integration due to their size and layout. Therefore, as far as possible, College VI students are asked to remain on site only for their scheduled lessons, working at home at other times. This arrangement will also be reviewed for the Summer Term.

Travelling to/from School

Students are reminded to walk or cycle to/from school, if possible. If using public transport, students must remember to wear a face mask and to show consideration for others by maintaining distance and demonstrating impeccable manners. If parents are dropping students off and/or picking students up by car, please refrain from driving up to the Collegiate gates, unless absolutely necessary. Ideally, cars will not come beyond the Derwent Drive junction. We must all do all that we can to avoid causing congestion and potentially large congregations.

Attendance & Punctuality

All students should attend school on time every day from 11th March 2021 unless unwell, self-isolating or symptomatic. Any other absences will be unauthorised, in accordance with normal procedures. If you have any particular concerns, please let us know and we shall work to reassure and support anyone who may be anxious about returning to school.

Catering

We shall continue to use all of our outlets to provide catering services at break and lunchtime and will now be able to offer a more extensive menu, including “hot boxes” at lunchtime. We shall no longer operate the pre-order and collection service, but sandwiches and snacks will be available for purchase at break and lunchtime. Please remember to ensure that you have credit on ParentPay.

Visitors

We will continue to communicate with parents via telephone, email or MS Teams, rather than face-to-face contact, as far as possible. We have now successfully used online Parents Evening facilities and will soon be developing this further with Year 9 Options Evening. Visitors will only be allowed on site in exceptional circumstances which means that it will be even more important to ensure that students come to school with everything that they need; parents will not be permitted to come to the site to drop off any forgotten items. Thank you for your understanding.

Site Developments & Changes to Bubbles

Before the recent site damage, the Facilities Team took advantage of a very quiet site and were able to accelerate a number of developments. Notably, the refurbishment of classrooms on the ground floor of the main College VI building has now been completed, providing a refurbished Media Suite in College VI and three further College VI specialist classrooms. In addition, all three DT workshops have been improved, either with new PCs or refurbishment. Consequently, we have been able to make some changes to the College VI Bubble and the Year 10 Bubble, both of which will ease student movement and reduce potential congestion (see Appendix A).

If you have any further questions about students' return to school, please do let us know. We look forward to seeing everyone back at the Collegiate next week.

Yours sincerely



Mr S Dey
Principal

APPENDIX A – “BUBBLES” MAP, MARCH 2021

Riddlesdown Collegiate



First Floor

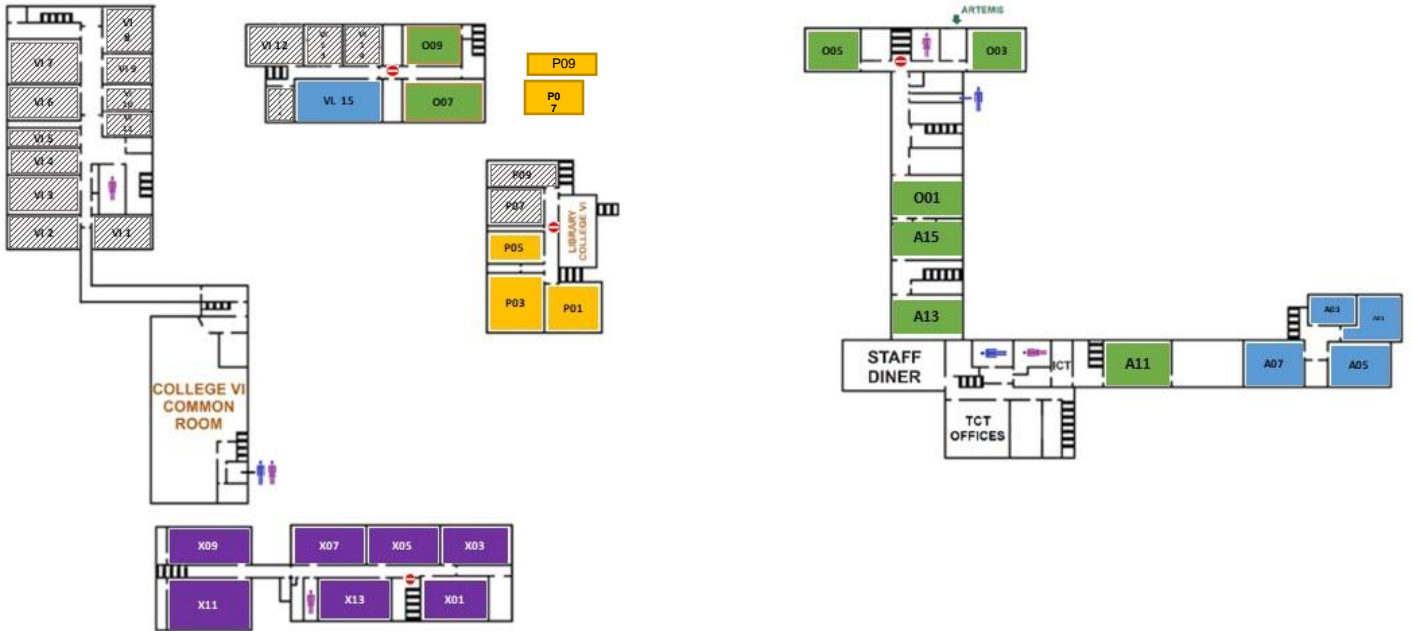

Ground Floor

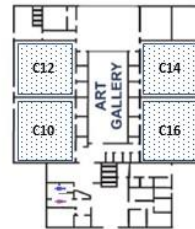

FIRE ASSEMBLY POINT

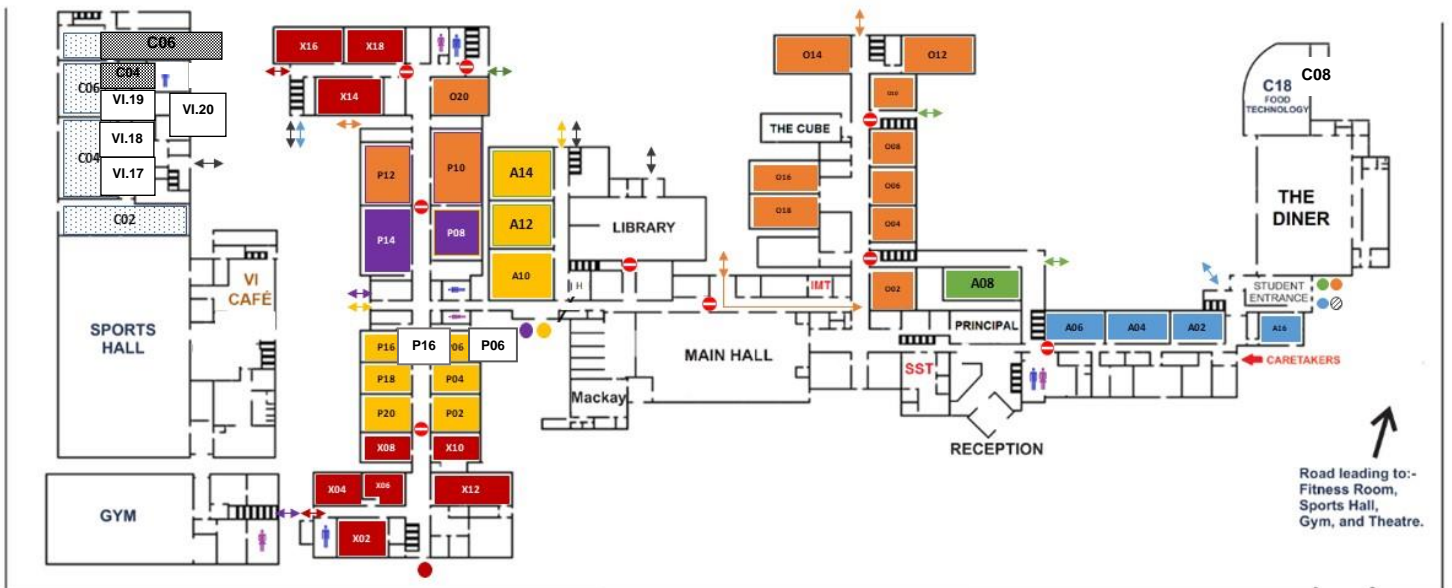

Front Gates and Dunmail Drive